



# GOVERNMENT GAZETTE

## OF THE

# REPUBLIC OF NAMIBIA

N\$1.20

WINDHOEK - 24 May 1999

No. 2109

### CONTENTS

#### GOVERNMENT NOTICE

Page

No. 92	Reservation of land from prospecting and mining operations over all areas covered by mineral rights issued to Tsumeb Corporation Limited (in liquidation): Minerals (Prospecting and Mining) Act, 1992 .....	1
--------	--	---

### Government Notice

#### MINISTRY OF MINES AND ENERGY

No. 92

1999

#### RESERVATION OF LAND FROM PROSPECTING AND MINING OPERATIONS OVER ALL AREAS COVERED BY MINERAL RIGHTS ISSUED TO TSUMEB CORPORATION LIMITED (IN LIQUIDATION): MINERALS (PROSPECTING AND MINING) ACT, 1992

Under the powers vested in me by section 122 (1) of the Minerals (Prospecting and Mining) Act, 1992 (Act 33 of 1992), I hereby declare that no person other than the holder of a reconnaissance licence shall, notwithstanding anything to the contrary contained in that Act or any other law, but subject to any right conferred upon the holder of any mining claim, exclusive prospecting licence, mineral deposit retention licence or mining licence by the Act before the date of this notice, and which exists on the date immediately before the date of this notice, carry on any prospecting or mining operations in, on or under any part of the areas described in Schedule I and shown on the relevant Diagram set out under Schedule II.

**J. NYAMU**  
**MINISTER OF MINES**  
**AND ENERGY**

Windhoek, 10 April 1999

**SCHEDULE I****AREA 1**

A certain area of land situated in the Oshikoto and Otjozondjupa Regions, in the Tsumeb, Otavi and Grootfontein Districts, Registration Division "B", approximately 1 411 961 hectares in extent and more specifically, bounded by a series of co-ordinated points A to C inclusive as listed hereunder, excluding that portion of such area that was previously withdrawn under Government Gazette No. 1270 of 1 March 1996 and as shown on Diagram I of the area in question.

Co-ordinates given in decimal degrees

POINT	LATITUDE	LONGITUDE
A	17.40	19.00
B	17.40	19.90
C	18.75	19.90
D	18.75	19.00

**AREA 2**

A certain area of land situated in the Khomas Region, Windhoek District, Registration Division "K", approximately 9 875 hectares in extent and more specifically, bounded by a series of co-ordinated points A to J inclusive as listed hereunder and as shown on Diagram II of the area in question.

Co-ordinates given in decimal degrees

POINT	LATITUDE	LONGITUDE
A	17.07	22.40
B	17.07	22.43
C	17.12	22.43
D	17.12	22.44
E	17.21	22.45
F	17.20	22.43
G	17.25	22.42
H	17.24	22.38
I	17.15	22.38
J	17.16	22.40

**AREA 3**

A certain area of land situated in the Khomas Region, Windhoek District, Registration Division "K", approximately 503 hectares in extent and more specifically, bounded by a series of co-ordinated points A to D inclusive as listed hereunder and as shown on Diagram III of the area in question.

Co-ordinates given in decimal degrees

POINT	LATITUDE	LONGITUDE
A	16.82	22.70
B	16.83	22.71
C	16.86	22.69
D	16.85	22.68

**AREA 4**

A certain area of land situated in the Erongo Region, Karibib District, Registration Division "H", approximately 731 hectares in extent and more specifically, bounded by a series of co-ordinated points A to D inclusive as listed hereunder and as shown on Diagram IV of the area in question.

## Co-ordinates given in decimal degrees

POINT	LATITUDE	LONGITUDE
A	15.22	22.35
B	15.23	22.36
C	15.25	22.34
D	15.24	22.33

## AREA 5

A certain area of land situated in the Kunene Region, Khorixas District, Registration Division "A", approximately 615 hectares in extent and more specifically, bounded by a series of co-ordinated points A to D inclusive as listed hereunder and as shown on Diagram V of the area in question.

## Co-ordinates given in decimal degrees

POINT	LATITUDE	LONGITUDE
A	14.44	20.76
B	14.46	20.79
C	14.47	20.78
D	14.46	20.75

Note: Detailed locality plans of the areas described in Schedule I can be inspected at the office of the Mining Commissioner, Aviation Road No. 1, Ministry of Mines and Energy, 2nd floor, Room 209, Windhoek.

SCALE 1:650 000

19.90 S  
18.75 E

# DIAGRAM II O

## LOCALITY PLAN OF EXCLUSIVE PROSPECTING LICENCES EPL - 367 AND EPL - 1776

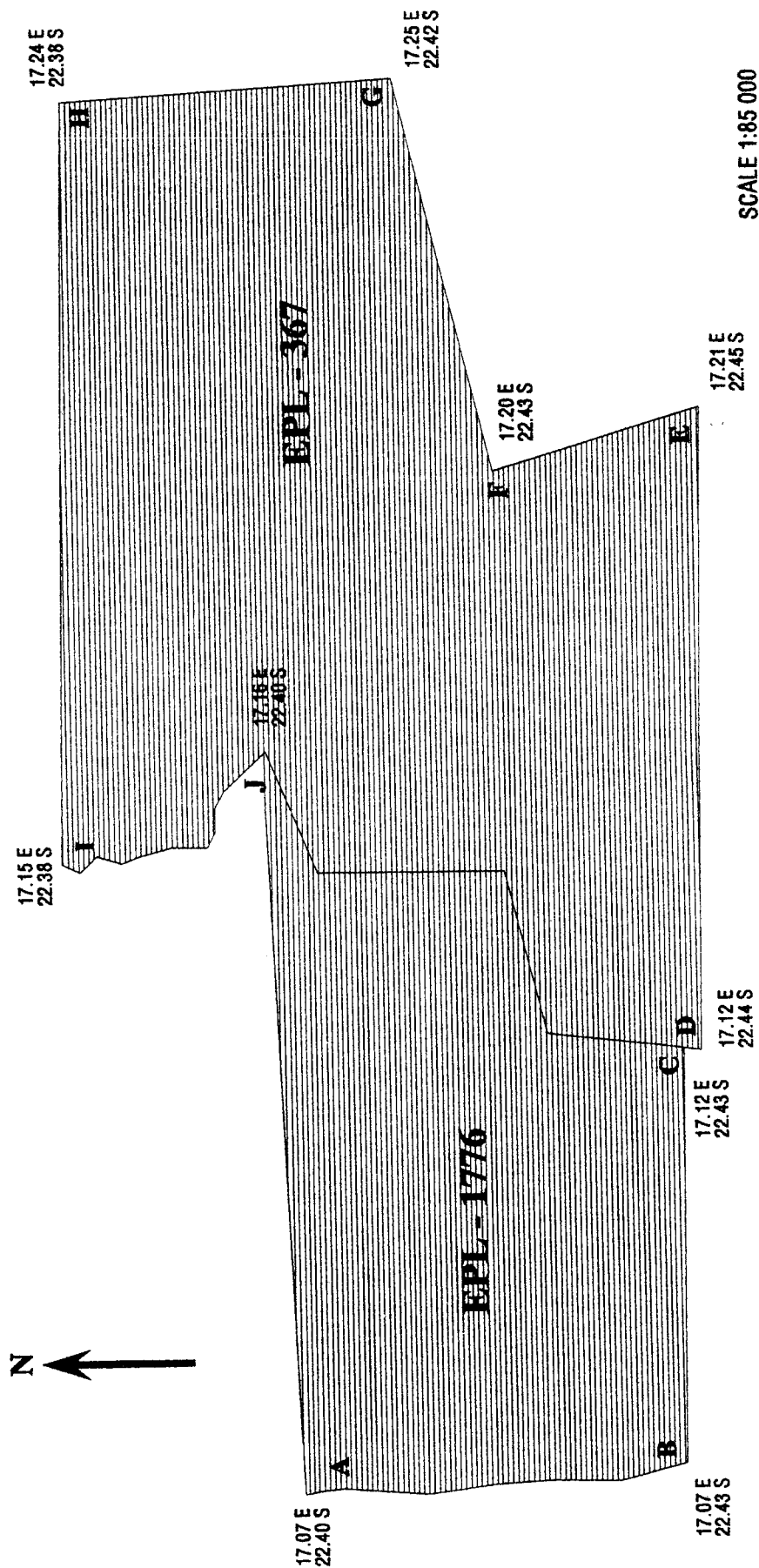

## DIAGRAM III

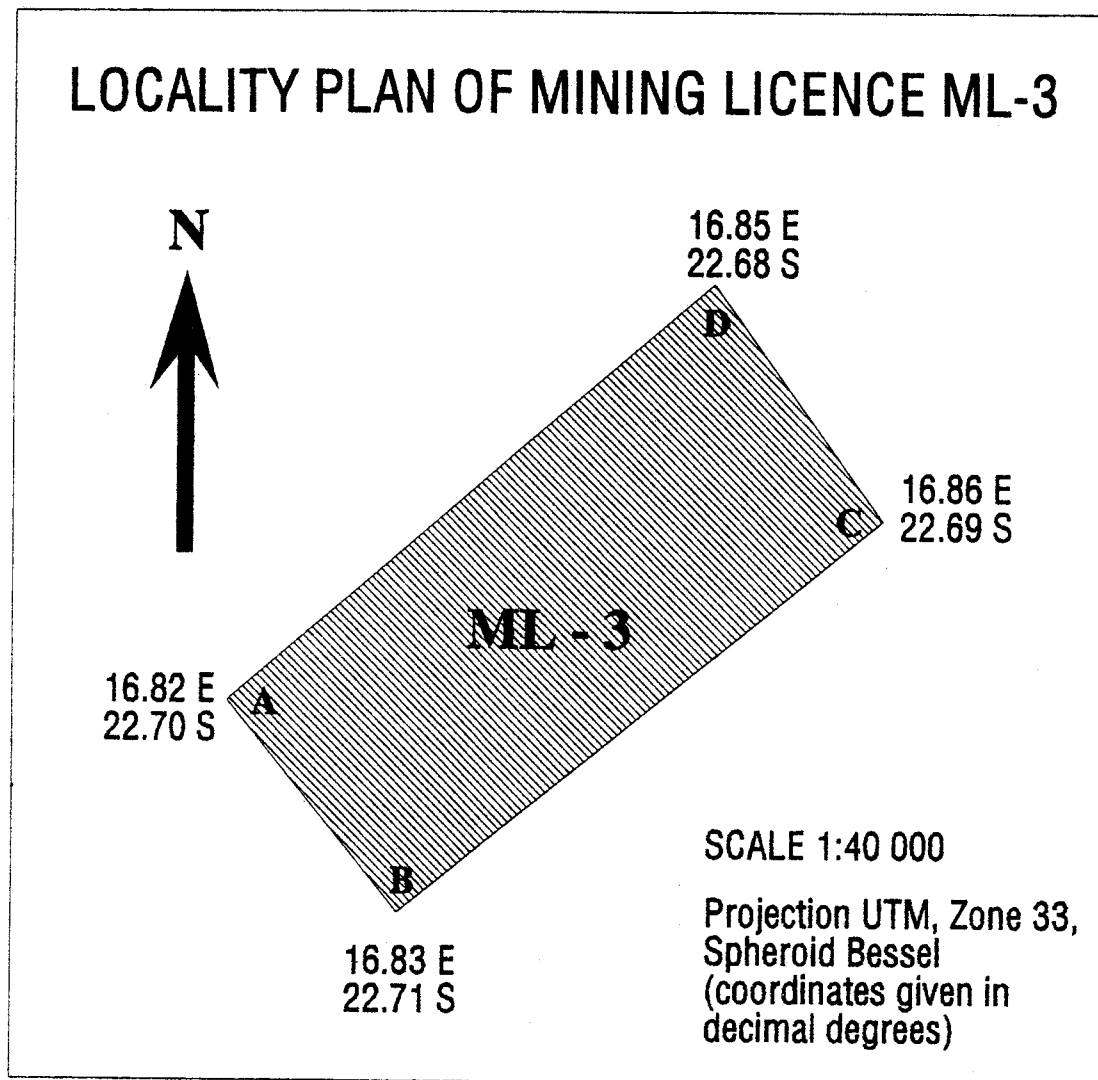

## DIAGRAM IV

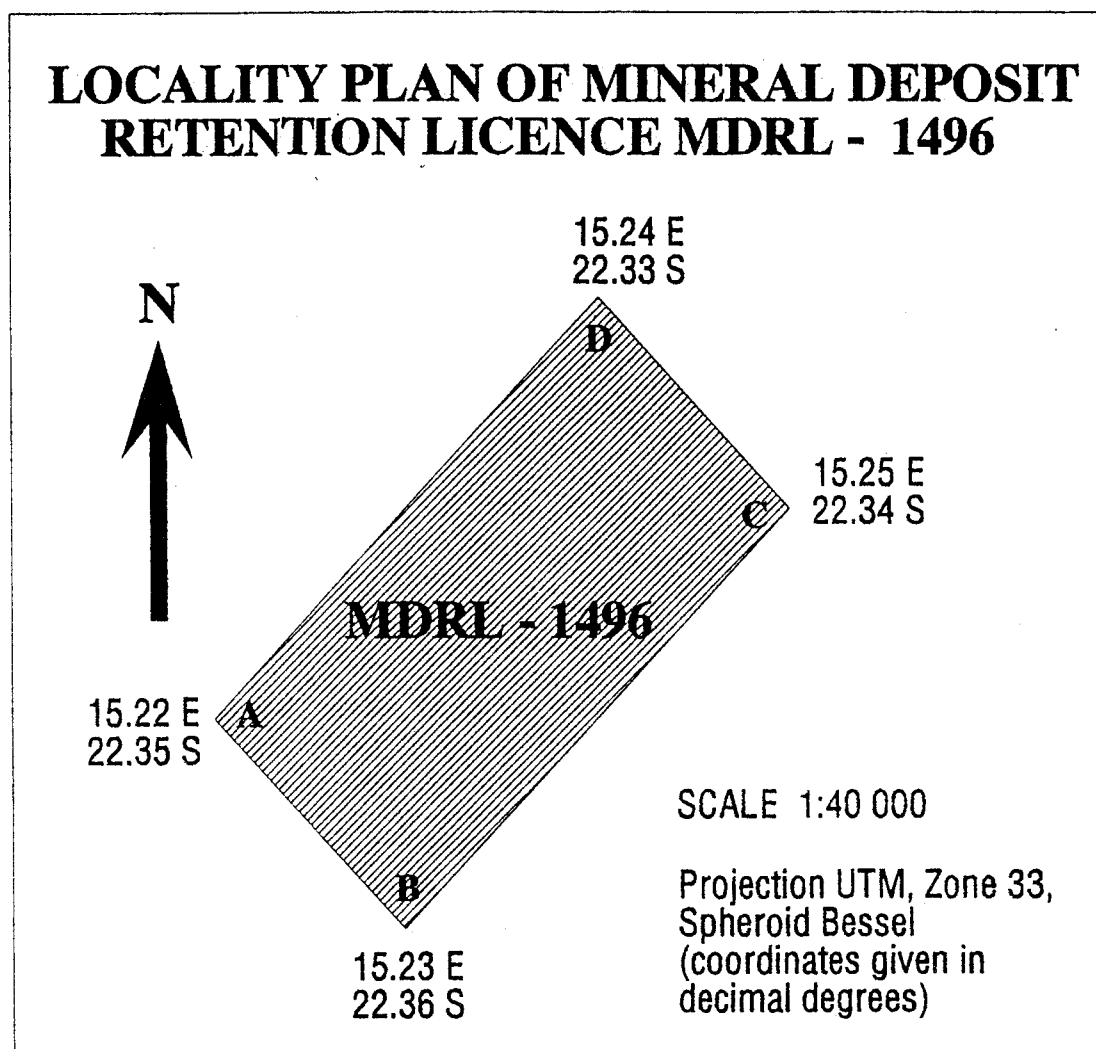

## DIAGRAM V

### LOCALITY PLAN OF MINING LICENCE ML - 24

